

USER MANUAL

Driverless Strip Light Configuration

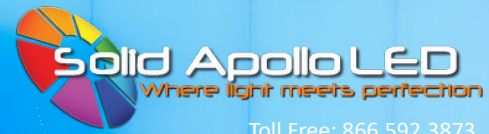

Toll Free: 866.592.3873
Email: sales@solidapollo.com
www.SolidApollo.com

Product Description

The Driverless LED Strip Lights come ready for customization to fit almost any lighting project. This user guide is intended to instruct anyone on how to rewire light strip, add interconnectors and joiners, and an endcap.

This user manual can be used when extra strip light has been left over from an installation or if extra strip light needs to be added, or during an installation where unexpected gaps or jumps are now required. Basically every part of making a fully waterproof and long lasting installation is covered in this user manual.

Main Functions:

- Power Adapter: For rewireing a piece of strip light
- Interconnector: Used for jumps and bends needed in an installation
- Joiner: Used for reconnecting strip lights
- Endcap: For adding a durable waterproof seal to the end of strip light

This manual reviews:

- Entire waterproof and configuration process
- How to add a power adapter
- How to install an interconnector or joiner
- How to add the endcap



Driverless Light Strip

USER MANUAL

Driverless Strip Light Configuration



Toll Free: 866.592.3873
Email: sales@solidapollo.com
www.SolidApollo.com

Installation

This section will show you how to cut the strip, add a power adapter to the strip, install an interconnector or joiner, and add an endcap to complete the configuration for a fully waterproof seal. **All driverless strip can only be powered in one direction.** When cutting strip, try to keep track of which end is cut. Please note, for outdoor or high humidity applications, we recommend using clear PVC cement for all connections (as noted in instructions), and we recommend at least 24 hours of drying time before installing or using the strip.

Tools Required:

- Sharp Metal Scissors or Shears (for cutting strip at cut points)
- Paper Towels (for excess glue)
- Tong or Tweezer (for prong removal during testing)

Warning: Light Strip must be unplugged when any modifications are performed. 120V AC Current is Dangerous and may cause electrical shock, injury and in some cases death.

Cutting the Strip:

Each strip has cut points every 19.5" (single color) or 18" (RGB). Refer to the diagrams below for the cut point symbol on each strip.

Types of Driverless Strip Cut Points:

Single Color

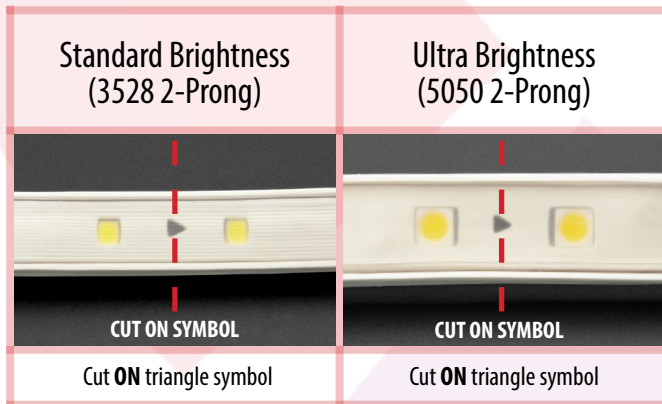

RGB



Warning: Any tool with a blade is dangerous, and caution is advised when handling any blade. Please make sure hands and fingers are kept at least several inches away from any blade and are not placed in the direction of the blade.

Warning: Failure to cut 1/16in **AFTER** the triangle symbol may result in the failure of the strip and will void the strip's warranty.

- 1 Find the cut point on the strip. Imagine a line passing across the strip with the center being on the cut symbol (single color) or 1/16in past the symbol (RGB). Line up scissors or shears perpendicularly to the cut point and cut through the strip.

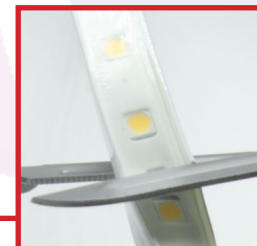

USER MANUAL

Driverless Strip Light Configuration



Toll Free: 866.592.3873
Email: sales@solidapollo.com
www.SolidApollo.com

Connector Orientation:

The orientation between the prongs and the connector must match for correct installation. The pointy end of the prong can only be inserted into the strip light. The barrel end (non-pointy end) of the prong can only be inserted into the connector. The prongs and barrel connectors must always be on the bottom (the LED's will be on top and visible when done correctly).

CORRECT ORIENTATION: FOR INSTALLATION

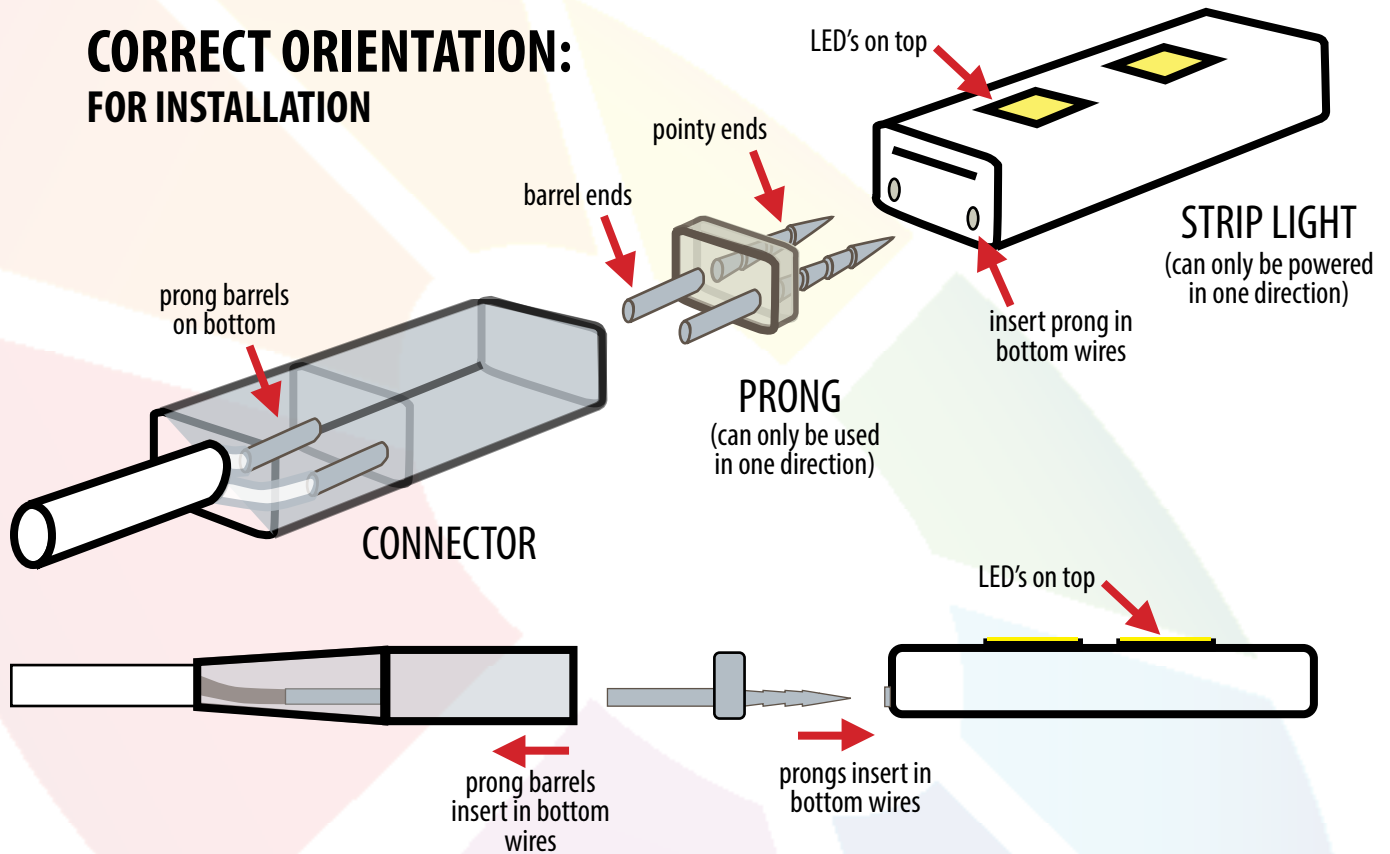

CORRECT ORIENTATION: AFTER CONNECTION

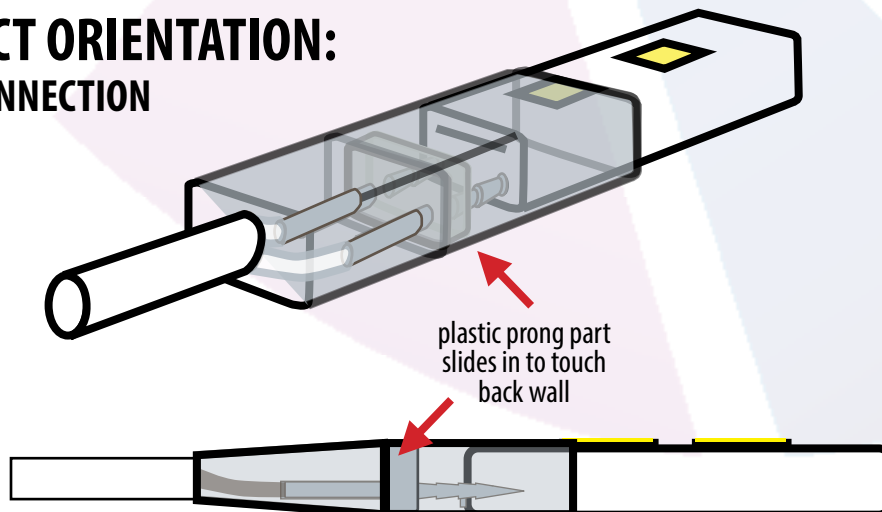

...continued on next page

USER MANUAL

Driverless Strip Light Configuration



Toll Free: 866.592.3873
Email: sales@solidapollo.com
www.SolidApollo.com

Pictures of Correct Connector Orientation

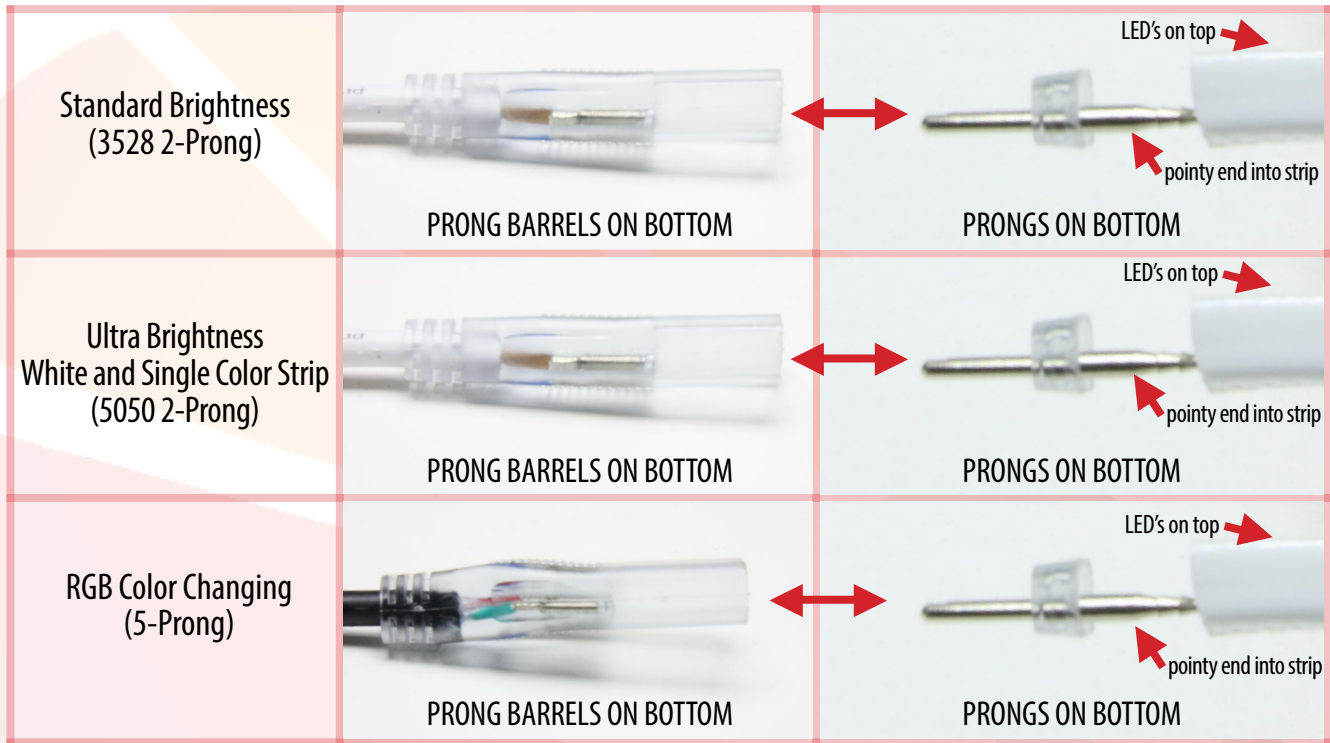

For more information see Page 12 for detailed pictures of the various types of driverless strip lights

Powering the Strip:

In this section you will learn how to add the power adapter to any cut point on the strip.

- 1 First, the components need to be tested to confirm they work before adding any glue. The strip light can only be powered from one end. If you are unsure which end is correct, one end at a time must be tested to find the correct end for adding power for the lights to work.

...continued on next page

USER MANUAL

Driverless Strip Light Configuration



Toll Free: 866.592.3873
Email: sales@solidapollo.com
www.SolidApollo.com

2 Take one end of the strip and a prong and line it up to the strip making sure the prong is oriented in the correct direction. Carefully insert the pointy end of the prong into exposed wire ends. Try to have each prong insert into the center of each exposed wire end. The prong needs to be inserted as far as possible without using excessive force.



CORRECT: ✓

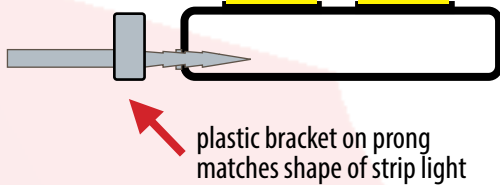

plastic bracket on prong matches shape of strip light

INCORRECT: ✗

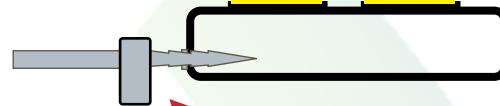

plastic bracket on prong does not match shape of strip light

3 Then take the strip with the prong and insert it into the power adapter connector in the correct orientation. The prongs will slide into the small barrels inside the connector.

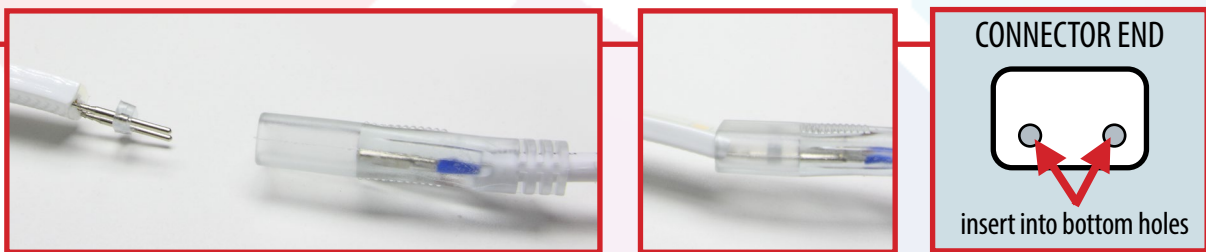

CORRECT: ✓



plastic bracket on prong slides in to touch back wall of connector

INCORRECT: ✗



Strip and prong inserted upside down

...continued on next page

USER MANUAL

Driverless Strip Light Configuration



Toll Free: 866.592.3873
Email: sales@solidapollo.com
www.SolidApollo.com

Driverless Strip Light Configuration

4 Take the plug on the power adapter and connect it into the wall outlet. **Warning: The opposite end of the strip has not been sealed and must not touch any conductive material or electric shock or injury could occur.** If the lights turn on, then the prong was inserted into the correct end of the strip light. If the lights do not come on, then unplug the power adapter and repeat from step 1 to test the opposite end of the strip light. Tweezers or tongs maybe required to remove the prongs if they are stuck inside the connector.



5 After confirming the lights work, **unplug the strip from the wall outlet.** Carefully pull the power adapter off the strip. The prongs are sometimes stuck inside the connector on the power adapter and require a set of tweezers or tongs to pull the prong out.

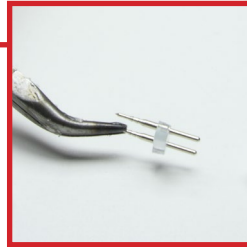

6 The test phase is now complete, and the lights, prong and connector can be assembled for the last time. Take the prongs and reinsert them into the strip in the correct orientation. The prong needs to be inserted as far as possible without using excessive force. Then take the connector end of the power adapter and fill it half way with PVC cement.

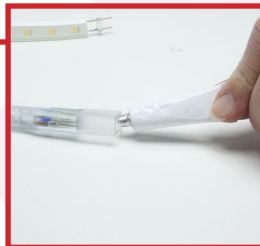

...continued on next page

USER MANUAL

Driverless Strip Light Configuration



Toll Free: 866.592.3873
Email: sales@solidapollo.com
www.SolidApollo.com

7 Take the strip with the prong and re-insert it into the connector of the power adapter, making sure it is inserted in the correct orientation. Push the strip and the connector together, until the plastic bracket on the prong touches the inner wall of the connector on the power adapter.

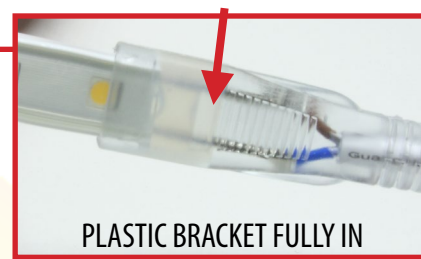

8 Extra glue usually comes out at the connection. Take your finger and wipe the excess glue all the way around the connection point. Wipe extra glue onto the paper towel. Please note the configuration is not complete until an endcap is added to the opposite end. If an interconnector is not required, skip the next section and go to page 11 for adding the endcap.

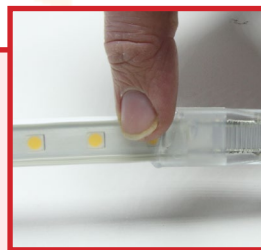

When configuration is complete, we recommend at least 24 hours of drying time before installing or using the strip. Be careful when handling strip while it is drying, as connections could come apart. We recommend taping the connections if the strip needs to be handled multiple times during configuration.

USER MANUAL

Driverless Strip Light Configuration



Toll Free: 866.592.3873
Email: sales@solidapollo.com
www.SolidApollo.com

Installing an Interconnector or Joiner:

In this section you will add an interconnector or joiner to any cut point on the strip. Any length interconnector will work as all the interconnectors use the same size connector at each end.

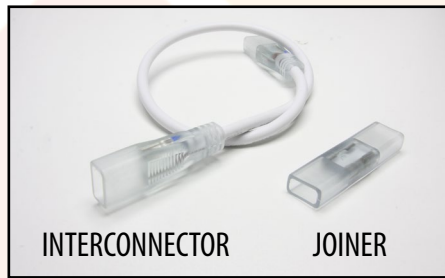

Interconnector: Used for jumps and bends, such as going around corners and tying two strips together over a long distance.

Joiner: Used for attaching extra light strips where no gaps are needed.

1 First, the components need to be tested to confirm they work before adding any glue. The strip light can only be powered from one end. If the extra piece of strip needs to be cut follow the rest of this step, otherwise skip to step 2. Find the cut point you want to add an interconnector to. Cut at the cutpoint as noted on page 2 titled "Cutting the Strip."

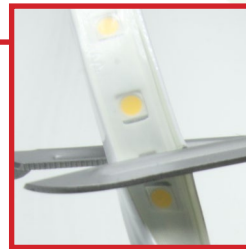
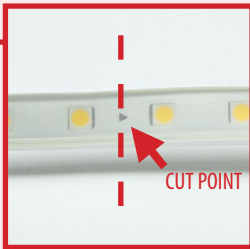

2 Take one end of the strip and a prong and line it up to the strip making sure the prong is oriented in the correct direction. Carefully insert the pointy end of the prong into exposed wire ends. Try to have each prong insert into the center of each exposed wire end. The prong needs to be inserted as far as possible without using excessive force.

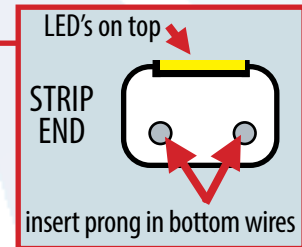
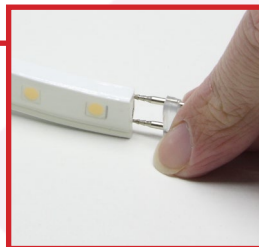

CORRECT: ✓

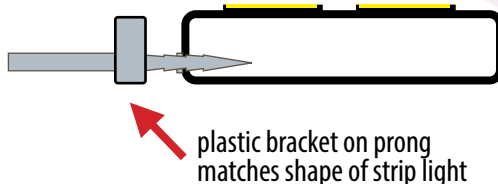

INCORRECT: ✗

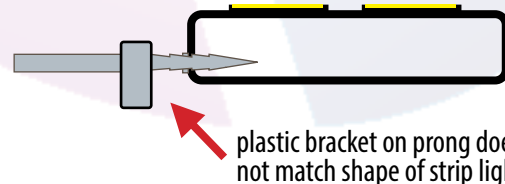

USER MANUAL

Driverless Strip Light Configuration

Driverless Strip Light Configuration

3 Then take the strip with the prong and insert it into the connector in the correct orientation. The prongs will slide into the small barrels inside the connector.

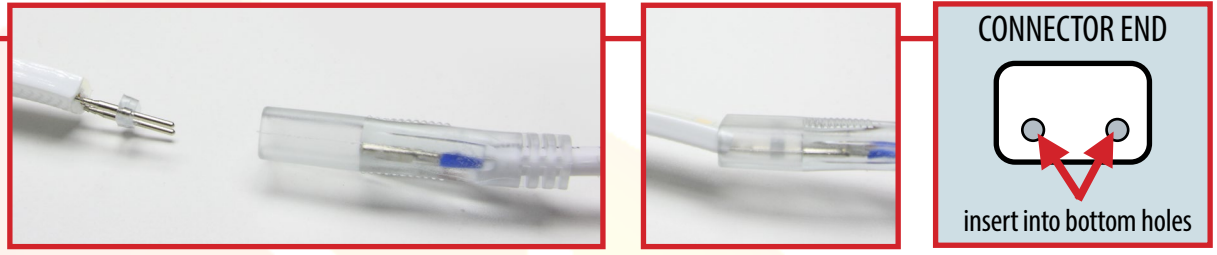

CORRECT: ✓

INCORRECT: ✗

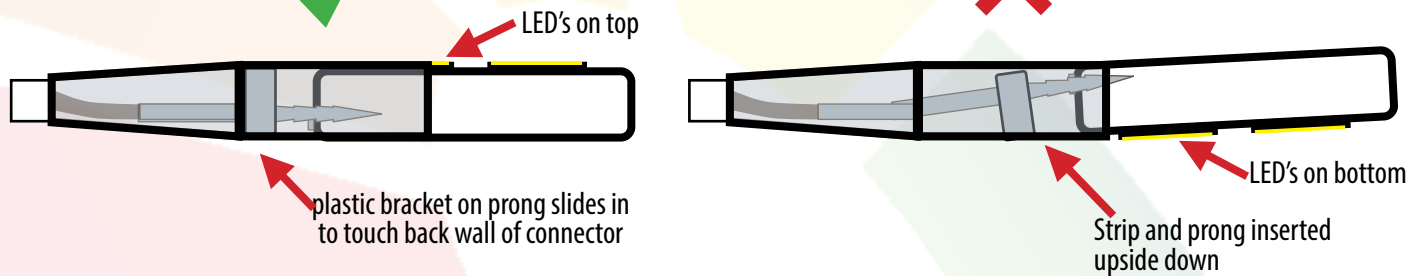

4 Repeat step 2 and 3 on the other end of the strip being attached to the interconnector or joiner. After completing the connection, Take the plug on the power adapter and connect it into the wall outlet. **Warning: The opposite end of the strip has not been sealed and must not touch any conductive material or electric shock or injury could occur.** If the lights turn on, then the connections were completed correctly. If the lights do not come on, then unplug the power adapter and visually check that the orientation of the prong and strip is correct in the connector. The prongs also could have been inserted incorrectly if one of the prongs did not go into the wire on the strip light. When disassembling, tweezers or tongs may be required to remove the prongs if they are stuck inside the connector.

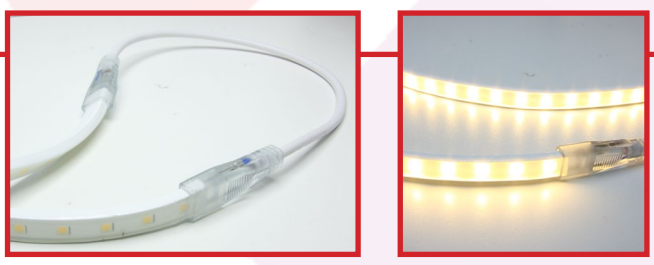

5 After confirming the lights work, **unplug the strip from the wall outlet.** Carefully pull the interconnector (or joiner) off the strip. The prongs are sometimes stuck inside the connector and require a set of tweezers or tongs to pull the prong out.



USER MANUAL

Driverless Strip Light Configuration

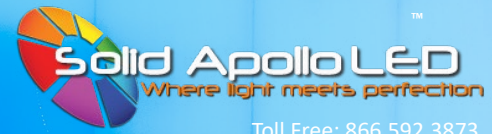

Toll Free: 866.592.3873
Email: sales@solidapollo.com
www.SolidApollo.com

Driverless Strip Light Configuration

6 The test phase is now complete, and the strip lights, prongs and interconnectors (or joiners) can be assembled for the last time. Take the prong and reinsert it into the strip in the correct orientation. The prong needs to be inserted as far as possible without using excessive force. Take one connector end and fill it half way with PVC cement.



7 Take the strip with the prong and re-insert it into the connector, making sure it is inserted in the correct orientation. Push the strip and the connector together, until the plastic bracket on the prong touches the inner wall of the connector.

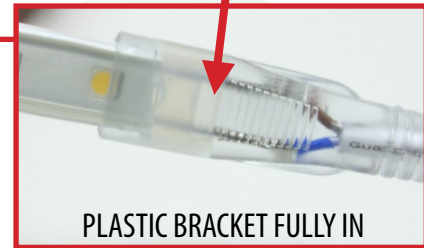

8 Extra glue usually comes out at the connection. Take your finger and wipe the excess glue all the way around the connection point. Wipe extra glue onto the paper towel. Repeat the connection on the other side of the interconnector (or joiner) by following steps 5 through 7 on this page. Please note the configuration is not complete until an endcap is added to the opposite end (covered in the next section on page 11).

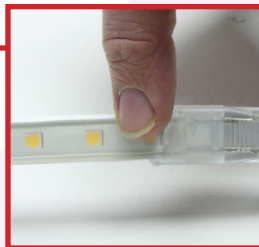

When configuration is complete, we recommend at least 24 hours of drying time before installing or using the strip. Be careful when handling strip while it is drying, as connections could come apart. We recommend taping the connections if the strip needs to be handled multiple times during configuration.

USER MANUAL

Driverless Strip Light Configuration



Toll Free: 866.592.3873
Email: sales@solidapollo.com
www.SolidApollo.com

Driverless Strip Light Configuration

Adding an Endcap:

In this section you will learn how to add an end cap to seal the end of the strip light.

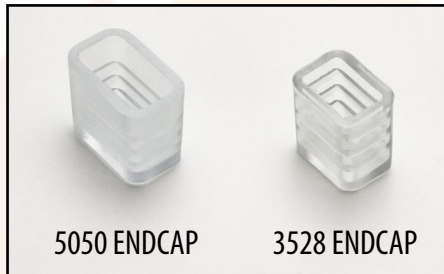

- 1 Take the endcap and fill it half way with PVC cement. Insert the endcap on the end of the strip until the inner back wall of the endcap is touching the end of the strip. Sometimes the endcap has to be wiggled from side to side so the back wall of the endcap touches the end of the strip.

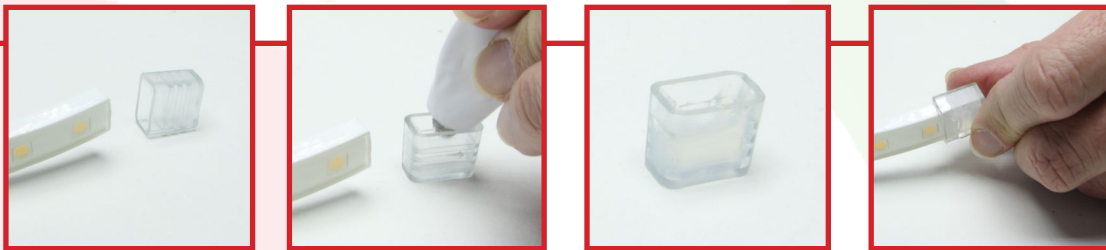

- 2 Extra glue usually comes out at the connection. Take your finger and wipe the excess glue all the way around the connection point. Wipe extra glue onto the paper towel.

For drying, we recommend at least 24 hours of drying time before installing or using the strip.

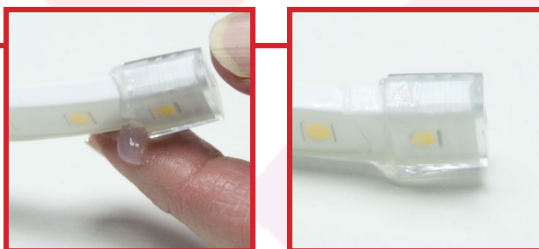

- 3 The configuration is now complete and ready for use.

If you have any further questions, please contact us by phone or email using the contact information at the top right of this page.

USER MANUAL

Driverless Strip Light Configuration



Toll Free: 866.592.3873
 Email: sales@solidapollo.com
 www.SolidApollo.com

Driverless Strip Light Configuration

Types of Driverless Strip and Matching Parts:

	Standard Brightness (3528 2-Prong)	Ultra Brightness White Strip (5050 2-Prong)	Ultra Brightness Single Color Strip (5050 2-Prong)	RGB Color Changing (5-Prong)
Light Strip				
Connector Type				
Prong				
Power Adapter				