

USER MANUAL

LumaBlaze LED Light Bar Configuration



Toll Free: 866.592.3873
Email: sales@solidapollo.com
www.SolidApollo.com

Product Description

The LumaBlaze High Power LED Light Bars bring incredible bright light to any location and have been designed for customization for a better fit than any light bar on the market. This user guide is intended to instruct anyone on how to attach a power supply, power the light bar, cut the Light Bar, connect light bars together, and install the light bar. Also if any extra light bar pieces leftover, this manual will instruct how to re-power and reuse these pieces.

This user manual can be used when installing the light bar underneath a variety of surfaces and to cut to the bar to length to fit in a specific area, and will cover how to install when gaps or jumps are required, and how to install in aluminum channels and profiles.

Main Functions:

- LumaBlaze Bar: Powerful Light Bar
- Sticky Back Tape: Strong Mounting on Flat Surfaces
- Push Wire Connectors: Easy Wire Connection
- Cut Points: For easy modification to light bar

Technical Features:

- Operating Voltage: 24V DC
- Max Power: 20W
- Cut Points: Every 4 inches
- 30 LED's per bar

This manual reviews:

- How to install the light bar
- How to connect and power the light bar
- How to cut the light bar
- How to connect multiple light bars
- How to re-power and re-connect left over pieces
- How to mount in aluminum profiles



LumaBlaze High Power LED Light Bar

USER MANUAL

LumaBlaze LED Light Bar Configuration



Toll Free: 866.592.3873
Email: sales@solidapollo.com
www.SolidApollo.com

Important Notes:

- We recommend installing the LumaBlaze on a metal surface at least 1/8th inch thick to increase the lifetime of the lights. We offer Aluminum Profiles which are perfect for the LumaBlaze.
- Do not connect more than 10 LumaBlaze Bars together
- Use at least 16 gauge wire for any connections
- Gently use the Push Down Connectors as they are very delicate

Adding Power:

This section will show you how to connect and power the LumaBlaze Light Bar. The LumaBlaze can be powered from either end and includes easy to read polarity markings (+ and -).

Tools Required:

Wire Stripper (To prepare wires for push connectors)

24V Power Supply (To power the LumaBlaze)

Wires (For making connections)

Barrel Connector (For connecting wires to Power Supply)

Finding the correct power supply:

To select the correct power supply for your specific requirements, you need to be aware of two requirements. First the amount of voltage has to match. The LumaBlaze requires a 24V power supply, so select one with 24V power. Second, the amount of wattage must be more than the amount of wattage used to power the LumaBlaze. One LumaBlaze bar uses 20W, so a power supply of at least 20W is required (plus a 10% buffer for electronic power supplies). In this case we recommend the 24W power supply. If 10 bars were used (20 Watts x 10 Bars = 200 Watts) a power supply with at least 200W (plus a 10% buffer for electronic power supplies) is required. In this case we recommend the 350W power supply.

For 1 light bar we recommend:

LED Power Supply 24V 24W

SKU: SA-PS-24V-1A-24W



For 10 light bars we recommend:

LED Power Supply 24V-DC-350W

SKU: SA-PS-24V-14A-350W



...continued on next page

USER MANUAL

LumaBlaze LED Light Bar Configuration



Toll Free: 866.592.3873
Email: sales@solidapollo.com
www.SolidApollo.com

LumaBlaze Configuration

- 1 Start by taking the 24V Power Supply and wire to connect the LumaBlaze with. **We recommend using at least 16 gauge wire for connecting the LumaBlaze.** Do not plug in the power supply at this time. Prepare the two wires that will connect to the LumaBlaze using the wire strippers. Make sure enough wire is exposed and is twisted into a single bundle to help create a solid connection. The wires can also be tinned with solder to help attach the wires more easily. See Page 9 for more detail on soldering.

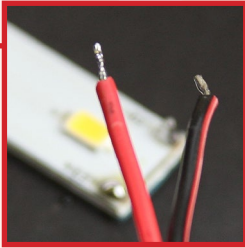

- 2 Take one wire, gently push down one of the wire connectors, then insert the wire in the correct location (make sure polarity is correct), then let go of the wire connector. Repeat this process for the second wire. **Please note the push down connectors are delicate and must be handled with care.**

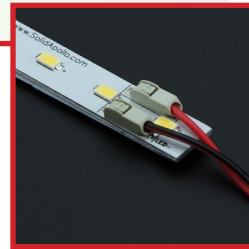
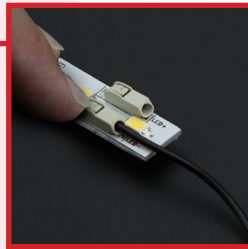
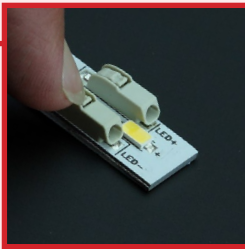

- 3 Check both wires are securely connected by gently tugging on the wires. If one or both easily pull out, repeat the process of sliding the wires into the wire connectors in step 2, but make sure the wires slide in further.

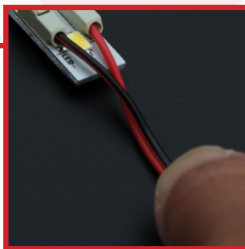

- 4 After the wires are connected, attach the wires to the power supply, then plug the power supply in. The LumaBlaze will turn on.

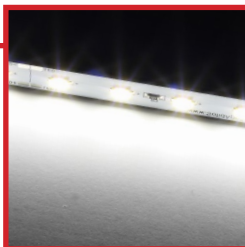

USER MANUAL

LumaBlaze LED Light Bar Configuration



Toll Free: 866.592.3873
Email: sales@solidapollo.com
www.SolidApollo.com

Connecting Multiple LumaBlaze Bars:

This section will show you how to connect multiple LumaBlaze LED Light Bars. Basically to connect two light bars, only 2 pieces of wire are needed.

- Use a short length of wire for connecting light bars next to each other in a linear format
- Use a slightly longer length of wire for bends
- Use a long length of wire for longer distances between light bars, for jumps and gaps.

Warning: Maximum of 10 LumaBlaze Bars can be connected together.

Tools Required:

Wire Stripper (To prepare wires for push connectors)

- 1 Take measurements of the location the LumaBlaze will be mounted. Take the light bars and place them in the configuration desired on a flat surface such as a table to plan how many connections will be needed and approximately how much wire will be required to connect.



- 2 Take a pair of wires then cut them to the desired length and prepare them using the wire strippers to strip a small amount of wire cover from the ends of the wire. Make sure enough wire is exposed and is twisted to help create a solid connection. The wires can also be tinned with solder to help attach the wires more easily. See Page 9 step 4 for more detail on soldering.

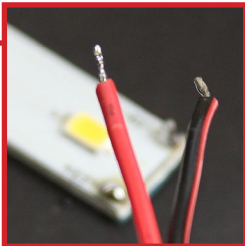

...continued on next page

USER MANUAL

LumaBlaze LED Light Bar Configuration



Toll Free: 866.592.3873
Email: sales@solidapollo.com
www.SolidApollo.com

LumaBlaze Configuration

3 Begin connecting the wires on the first LumaBlaze. Take one wire, push down one of the wire connectors, then insert the wire in the correct location, then let go of the wire connector. Repeat this process for the second wire. **Please note the push down connectors are delicate and must be handled with care.**



4 Then repeat connecting the wires to the second LumaBlaze. Repeat the process step 3 for each LumaBlaze installed next.

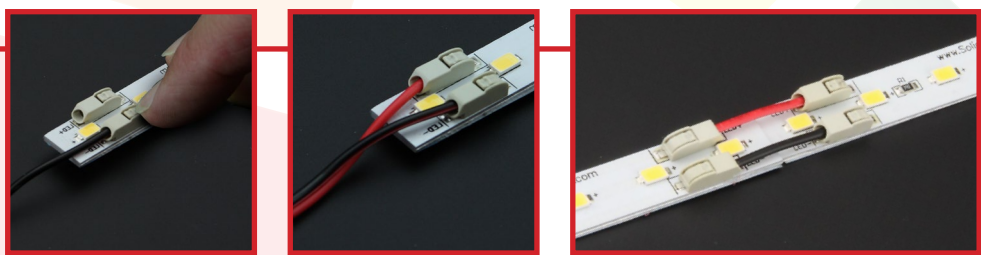

5 Take the first LumaBlaze and install it on the surface following the directions on page 6. Then take the second LumaBlaze and install it on the surface.



USER MANUAL

LumaBlaze LED Light Bar Configuration



Toll Free: 866.592.3873
Email: sales@solidapollo.com
www.SolidApollo.com

Cutting the light bar:

This section will show you how to cut the LumaBlaze Light Bar. The LumaBlaze has cut points every 4 inches and is made with 2mm thick aluminum printed circuit board, and the left over LumaBlaze pieces are easy to re-power (see page 8)

Warning: Any tool with a blade is dangerous, and caution is advised when handling any blade. Please make sure hands and fingers are kept at least several inches away from any blade and are not placed in the direction of the blade.

- 1 Check the LumaBlaze will fit. Take the LumaBlaze bar and hold it up to the location where it will be placed. The LumaBlaze has cut points every 4 inches. Find the cut point closest to the end of the installation area.



- 2 Take the LumaBlaze Bar back down. Take a pair of tin snips or nippers to cut with. Find the cut point location. Hold the tin snips up to the cut line. Firmly hold the light bar with your other hand. Carefully snip the light bar along the black cut line.

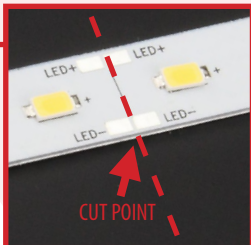

- 3 Take the cut piece and install.



USER MANUAL

LumaBlaze LED Light Bar Configuration



Toll Free: 866.592.3873
Email: sales@solidapollo.com
www.SolidApollo.com

Installation:

This section will show you how to install the LumaBlaze Light Bar. The LumaBlaze includes strong double sided thermal conductive tape and is recommended being installed on a metal surface to help with heat dissipation. We recommend using our Aluminum Profiles as the LumaBlaze easily fits in. Even though LED's do not generate much heat, the heat that is produced needs to be eliminated to ensure the maximum lifespan is achieved.

Please Note: We highly recommend installing the LumaBlaze on a metal surface at least 1/8th inch thick.

- 1 Check the LumaBlaze will fit. Take the LumaBlaze Light Bar and hold it up to the location where it will be attached. Make sure the surface is flat and clean. If the light bar needs to be cut, go to page 6 to cut the LumaBlaze before permanently attaching the light bar.



- 2 Connect the power wires to the start of the light bar as shown on page 2. If extra light bars need to be connected please refer to page 4. Begin un-peeling a short amount of tape cover from the back of the light bar.

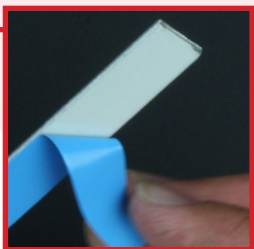

- 3 Take the light bar and hold it up to the surface being attached. While holding peel away the rest of the tape and gently push the light bar into place. Hold the light bar against the surface for 10 seconds.

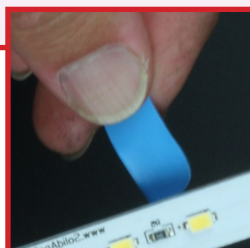
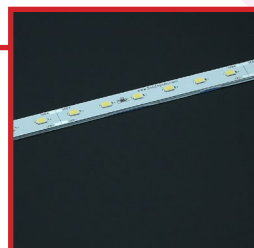

...continued on next page

USER MANUAL

LumaBlaze LED Light Bar Configuration

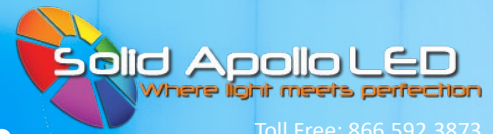

Toll Free: 866.592.3873
Email: sales@solidapollo.com
www.SolidApollo.com

LumaBlaze Configuration

- 4 Then carefully let go making sure the light bar is securely attached to the surface.



Connecting Previously Cut-Off Pieces:

This section will show you how to connect previously cut-off pieces which do not have the push down connectors on both ends. This section will cover how to solder new wires onto the included solder pads located at each cut point on the LumaBlaze. After attaching wires, the cut-off piece can be connected to a power supply, or added onto existing lighting installations for even more amazing lighting.



Warning: A Soldering Iron can become very hot. Follow all of the manufactures guidelines and safety precautions to prevent injury and in some cases death. While Soldering make sure you are in a well ventilated area. Breathing in excessive fumes during soldering can be harmful to your health.

Tools Required:

- Wire Stripper (To prepare wires for push connectors)
- Soldering Iron (To solder wires to LumaBlaze)
- Solder (material required to make solder connections)

- 1 Take the left over piece of LumaBlaze which requires a pair of wires to use. Then take a soldering iron and solder material to create a small puddle of solder on each solder pad. Begin by heating the soldering iron to the appropriate temperature.

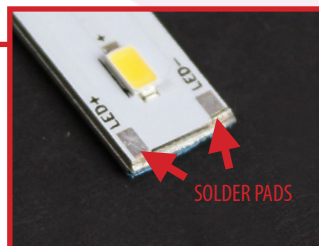

...continued on next page

USER MANUAL

LumaBlaze LED Light Bar Configuration



Toll Free: 866.592.3873
Email: sales@solidapollo.com
www.SolidApollo.com

LumaBlaze Configuration

2 Hold the soldering iron over one solder pad. Slowly add a small amount of solder onto the soldering iron (over the solder pad area).

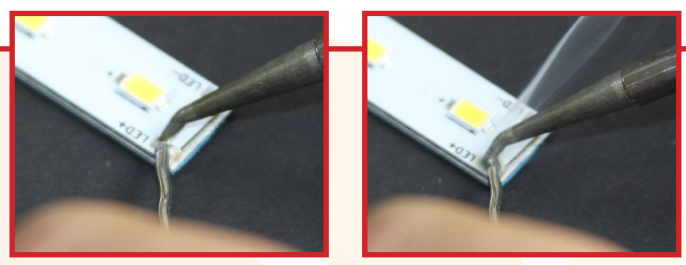

3 Then slowly lower the soldering iron until a small amount of solder comes off and onto the solder pad. The solder pad should have a small puddle of solder material about the size of the solder pad. If not, add more material. Repeat this process to add a puddle of solder on the other solder pad.

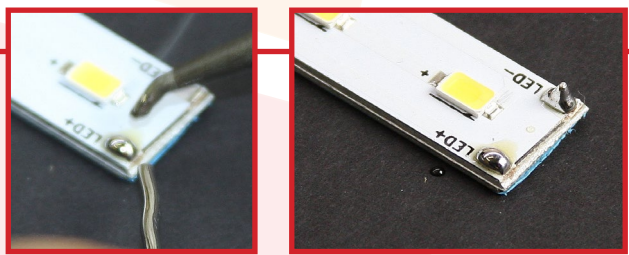

4 Take one piece of wire, and use wire strippers to prepare the wire. To help with connecting the wires, we suggest tinning the wire, by adding a small amount of solder on the exposed wire ends by using the soldering iron and solder material to add a light coating of solder. To attach the wire, place the exposed wire end next to the solder puddle.

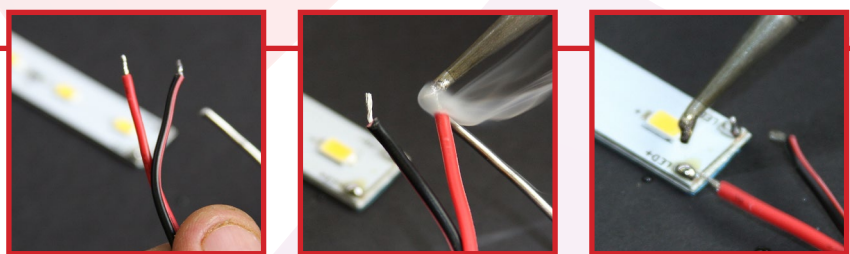

5 Take the soldering iron and slowly place it on the solder puddle. Allow the puddle to heat up (will take less than a few seconds) and then insert the wire into the center of the solder puddle. Remove the soldering iron while holding the wire in place.

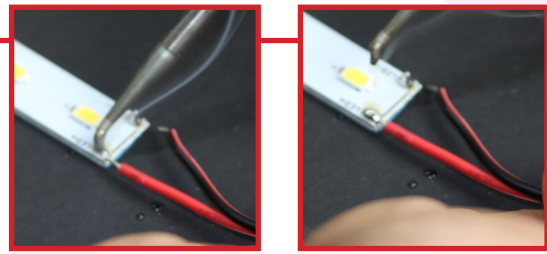

...continued on next page

USER MANUAL

LumaBlaze LED Light Bar Configuration



Toll Free: 866.592.3873
Email: sales@solidapollo.com
www.SolidApollo.com

LumaBlaze Configuration

- 6 After a few seconds let go, then gently tug on the wire to make sure it is securely connected to the solder puddle. If the wire comes out, repeat step 5. Then repeat this process for the other wire.

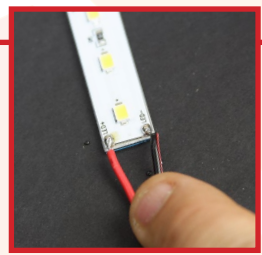

Installing in Aluminum Channels / Profiles:

This section will show you how to correctly place the LumaBlaze in an aluminum profile. The LumaBlaze is 0.47" wide, make sure the profile being used is at least this wide.

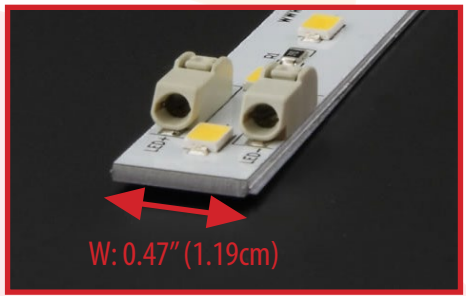

- 1 Take the aluminum profile and the LumaBlaze and test fit them together. Lay the LumaBlaze in the center of the channel, close to the end. (Extra room maybe required for an end cap and for wiring to come together and exit out.)

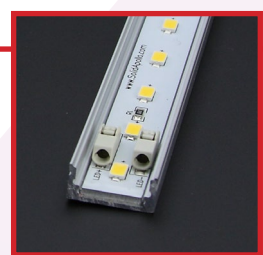

- 2 Take the LumaBlaze out of the aluminum profile and turn it over. Peel away a short amount of cover over the sticky back material. Carefully place the LumaBlaze back in the profile being careful to lay it in the center of the area in the profile.

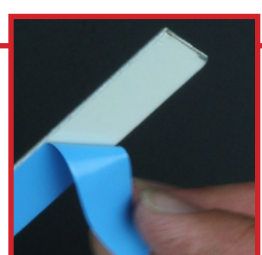

...continued on next page

USER MANUAL

LumaBlaze LED Light Bar Configuration



Toll Free: 866.592.3873
Email: sales@solidapollo.com
www.SolidApollo.com

- 3 Hold the LumaBlaze in place with one hand, and with the other, begin pulling the rest of the cover from the sticky back material. Hold the LumaBlaze in place for 10 seconds, and then let go.

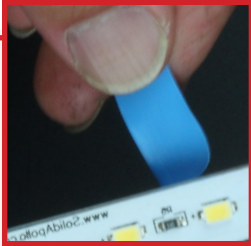

- 4 Gently tug on the LumaBlaze to make sure it has made a secure connection. If the bar does not stick in the profile, remove the LumaBlaze and clean the profile surface. When the surface is dry, carefully place the LumaBlaze back in the profile.



- 5 If extra LumaBlaze Bars need to be connected refer to page 4 as the bars are permanently placed in the profile. If any LumaBlaze Bars require cutting to a shorter length refer to page 6.

Technical Specifications:

Lumens Total:	1750 Lm
Lumens Per Foot:	1050 Lm
Total LED's:	30
Operating Voltage:	24V DC
Watts Per Foot:	12W
Max Power:	20W
Dimmable:	Yes
CRI:	85
LED Type:	SMD 5730
Beam Angle :	180

If you have any further questions, please contact us by phone or email using the contact information at the top right of this page.